

écologis





REVÊTEMENT D'ALUMINIUM FINI BOIS

ALUMINUM WOOD FINISH SIDING



REVÊTEMENT D'ALUMINIUM FINI BOIS

Luxor Architectural est fier d'introduire sa gamme de revêtement d'aluminium au fini bois. Nous comptons sur une expérience de plus de 75 années dans la fabrication de produits d'aluminium.

Nos revêtements sont le fruit de 8 années de R&D.

- ♦ **Alternative au bois conventionnel:** Notre collection de produits combine la force de l'aluminium à la durabilité de notre fini en faisant un produit supérieur comme bouclier aux alinéas de notre climat.
- ♦ **Finis bois spectaculaires:** L'installation des produits de revêtements Luxor fini bois est un investissement qui aura des répercussions immédiates sur la valeur de votre maison.
- ♦ **Sans entretien:** Pratiquement sans entretien. Les revêtements Luxor n'auront jamais besoin d'être repeints, ils ne craqueront pas et ne pourriront pas.
- ♦ **Facile à installer:** Notre longueur standard de 19 pieds résulte en moins de joints d'assemblage. Nous estimons à 30%, l'économie de coût de main d'œuvre pour l'installation de nos produits.



ALUMINUM WOOD FINISH SIDING

Luxor Architectural is proud to introduce its line of Aluminum wood finish siding.

This product is the result of 8 years of R&D.

- ♦ **Alternative to conventional wood:** Our product combines the strength of aluminium and the durability of our finish. It is the best answer against the harsh elements of our climate.
- ♦ **Spectacular wood finish:** The addition of our products to your project will reflect in an increase in value of your house.
- ♦ **No maintenance:** Practically no maintenance. Our siding will require no re-painting, they will not crack or rot.
- ♦ **Easy to install:** Our standard 19 feet length will result in less assembly. We estimate at 30%, the reduction in installation costs.



DIMENSIONS

LUXOR RÉSIDENTIEL

Luxor Industriel et Commercial

Nos produits remplissent aussi bien leur mission tant dans un milieu résidentiel, qu'industriel ou commercial.

LUXOR RESIDENTIAL

Luxor Industrial and Commercial

Our products are used in residential, commercial or industrial applications.



- ◆ Adapteur 1 pouce
- ◆ Adaptor 1 inch



- ◆ Planche 2.5 pouces
- ◆ 2.5 inches plank



- ◆ Planche 4 pouces
- ◆ 4 inches plank



- ◆ Planche 6 pouces
- ◆ 6 inches plank



- ◆ Planche 12 pouces
- ◆ 12 inches plank





DESSIN
DE PRODUITS
PRODUCTS DRAWINGS



MOULURE DE COIN EXTERNE 90DEG. 90 DEG. EXTERIOR MOLDING

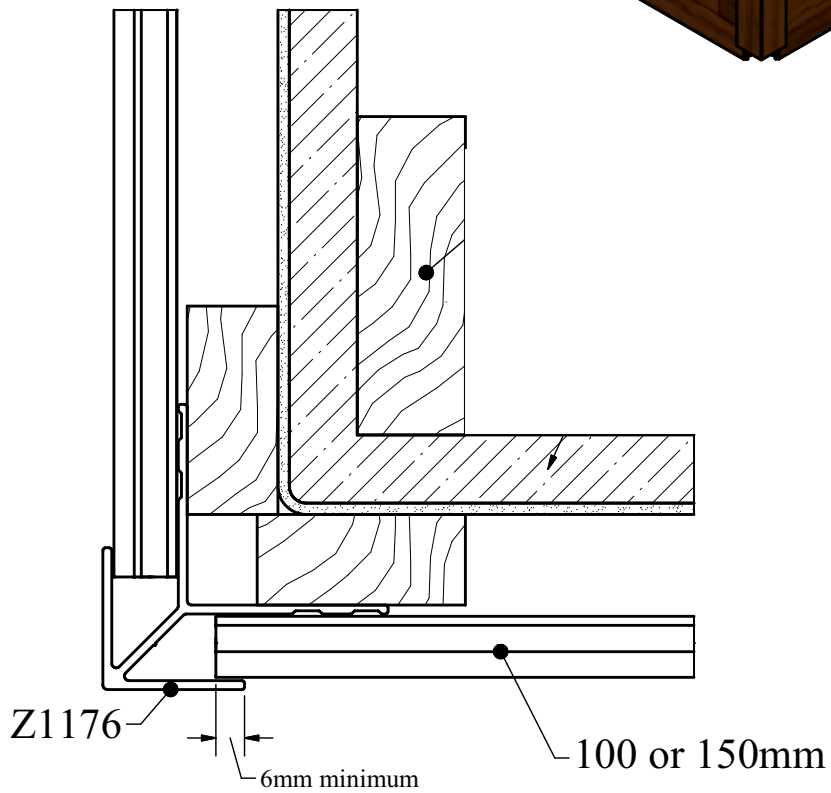
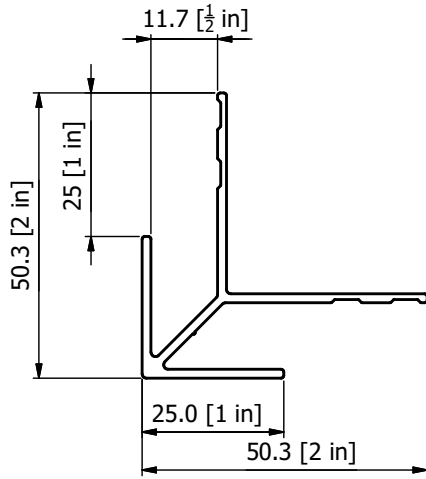

2 1/2 PERFORÉ PERFORATED 2 1/2

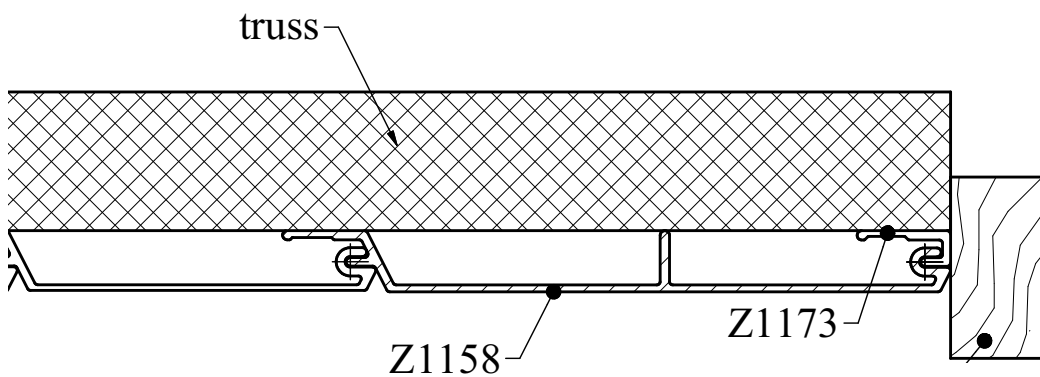
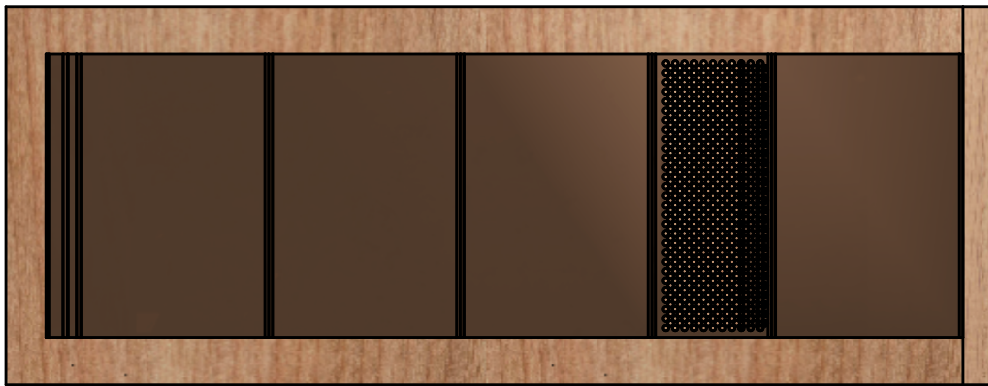
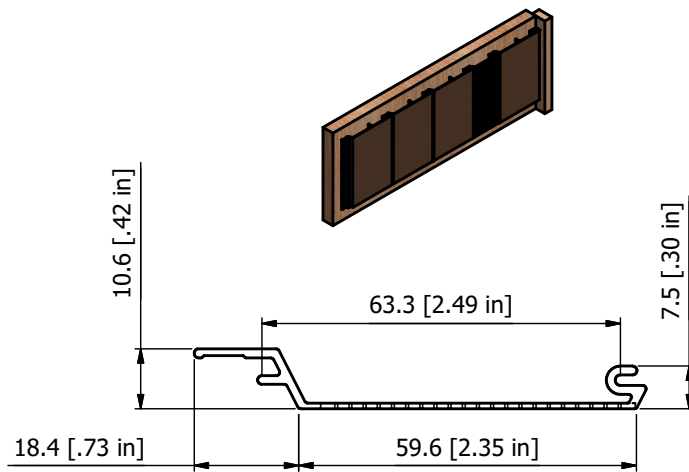

MOULURE DE DÉPART STARTER MOULDING

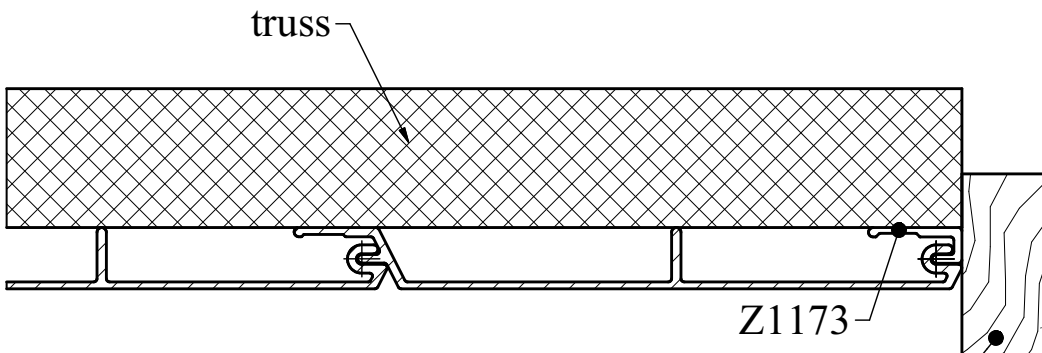
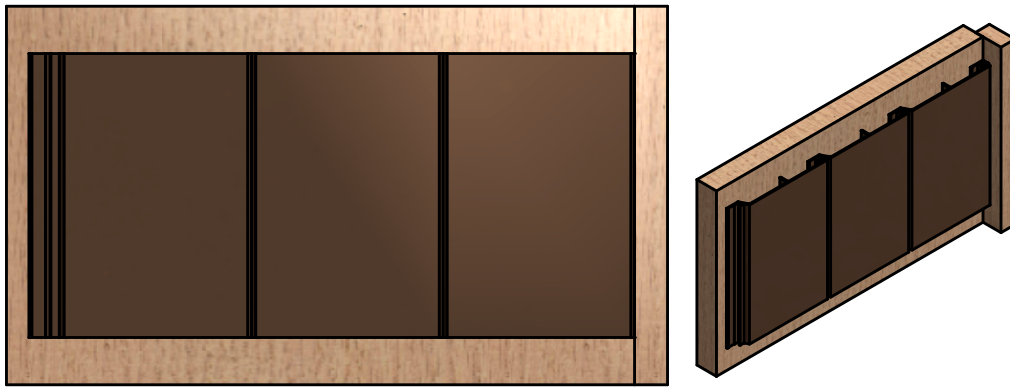
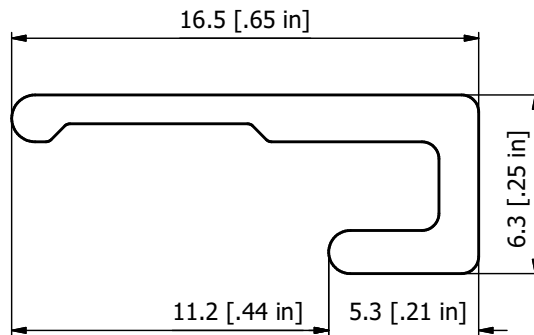

MOULURE DE FINITION FINISHING MOULDING



PLANCHE 6 PO. 6 IN. PLANK



ADAPTATEUR 1 PO. 1 IN. ADAPTOR

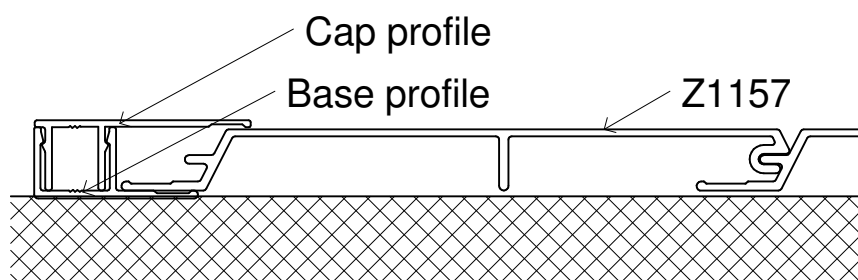
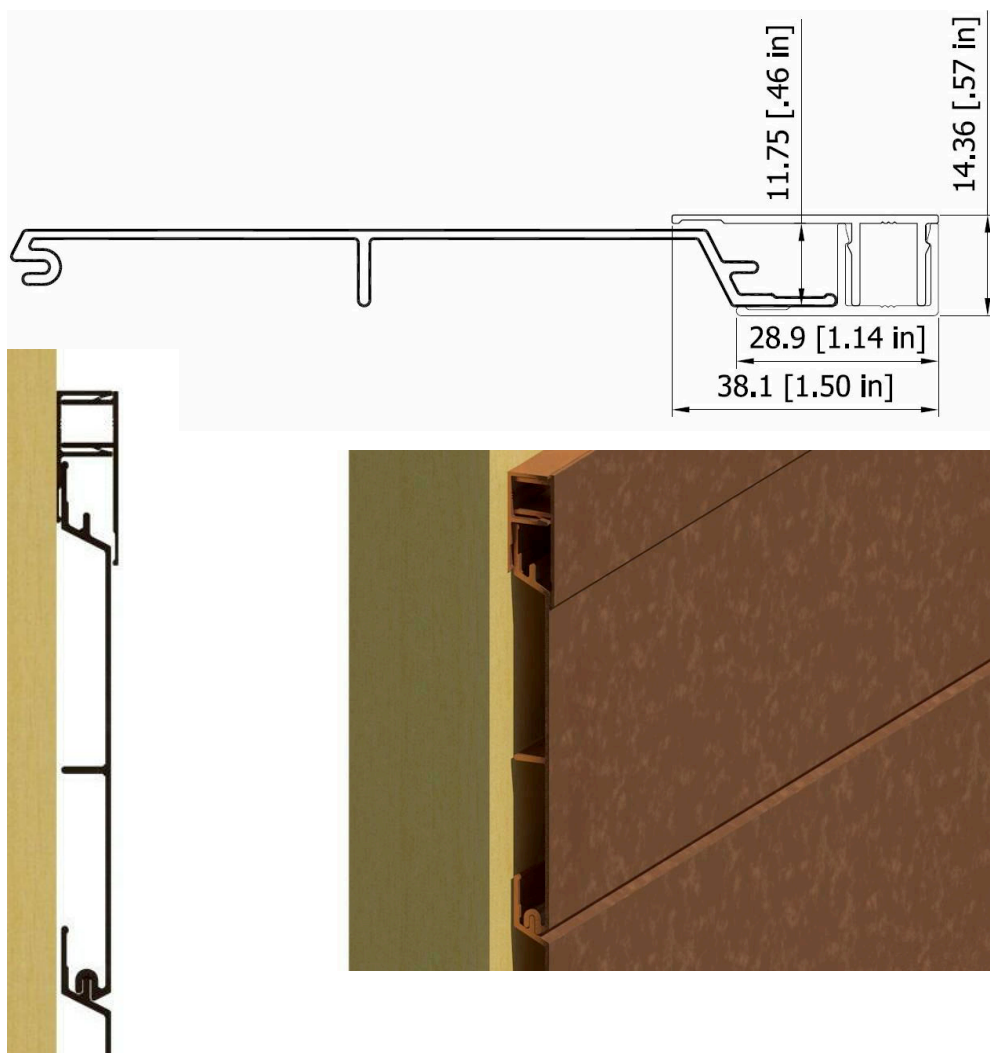
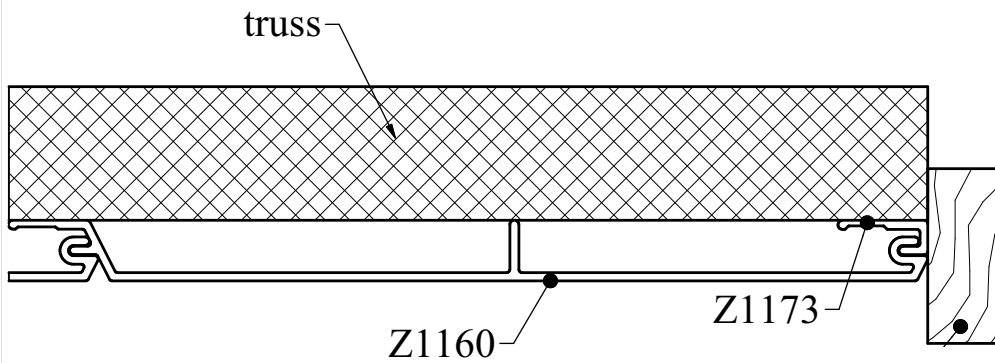
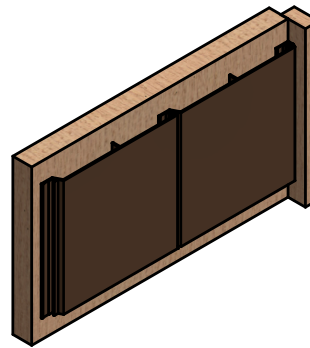
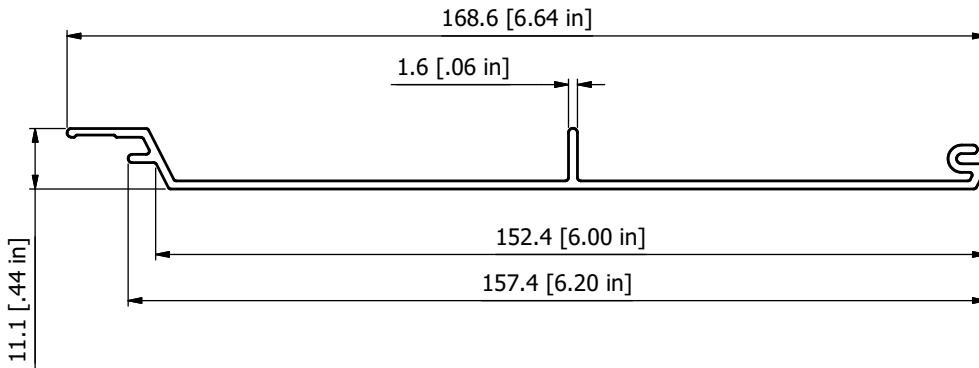

PLANCHE 2 1/2 2 1/2 PLANK



PLANCHE 4 PO.
4 IN. PLANK

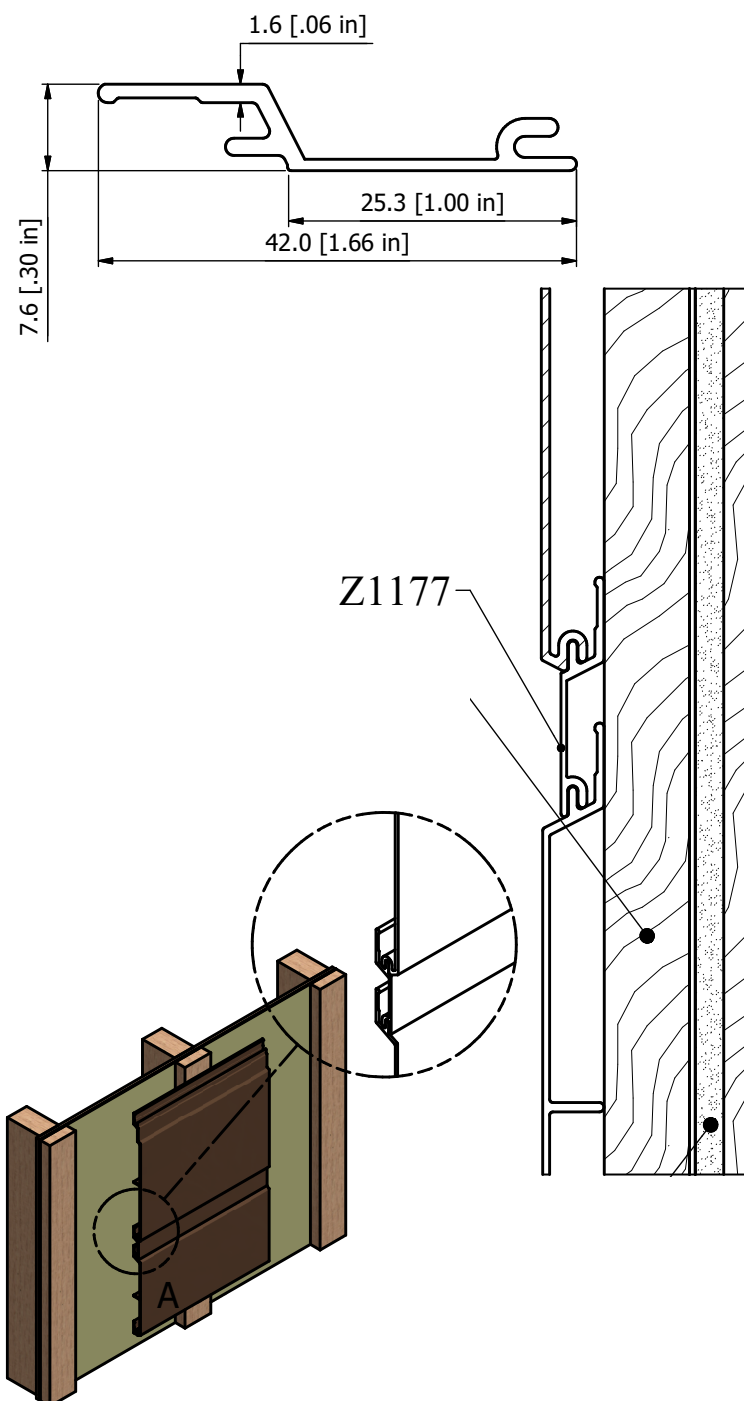

MOULURE DE COIN INTERNE 90 DEG. 90 DEG. INTERIOR MOLDING

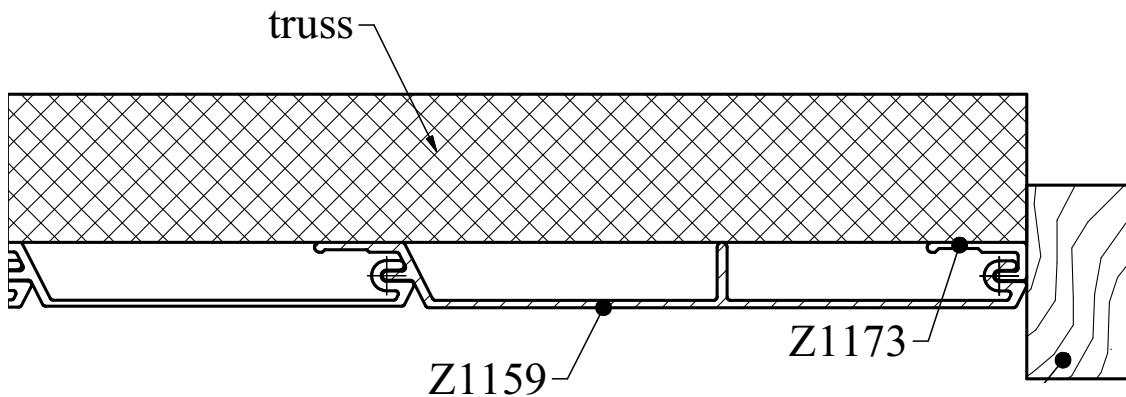
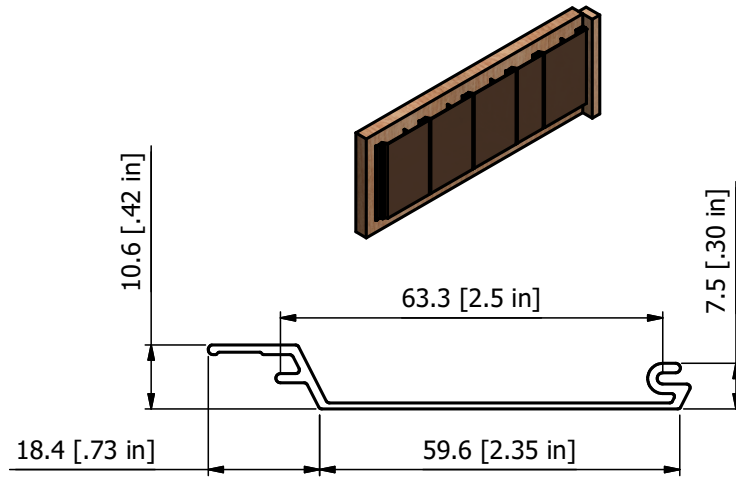
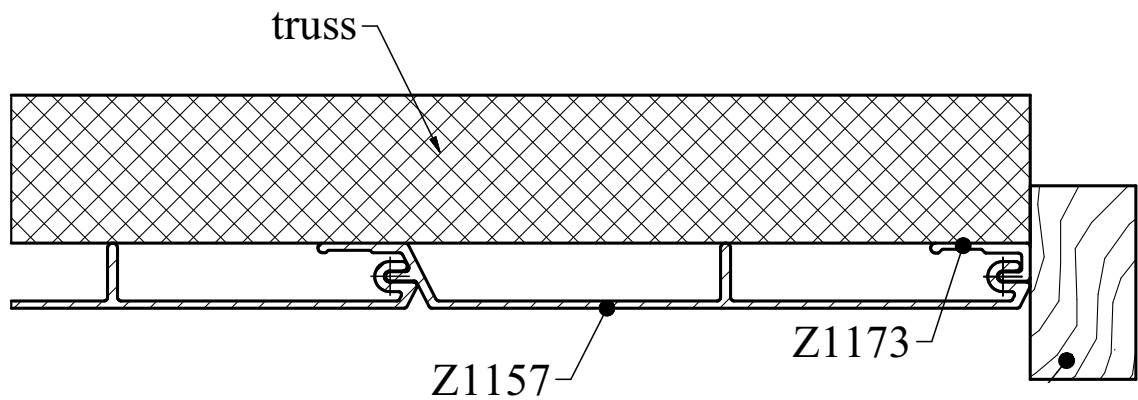
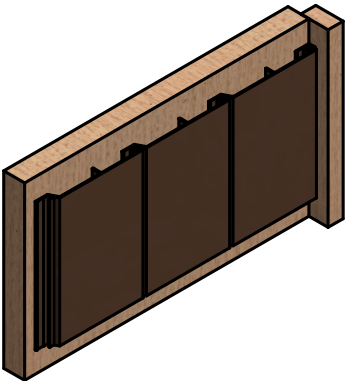
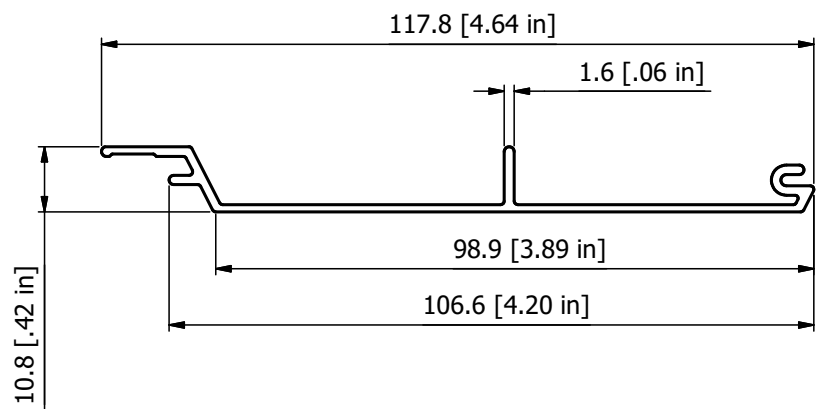
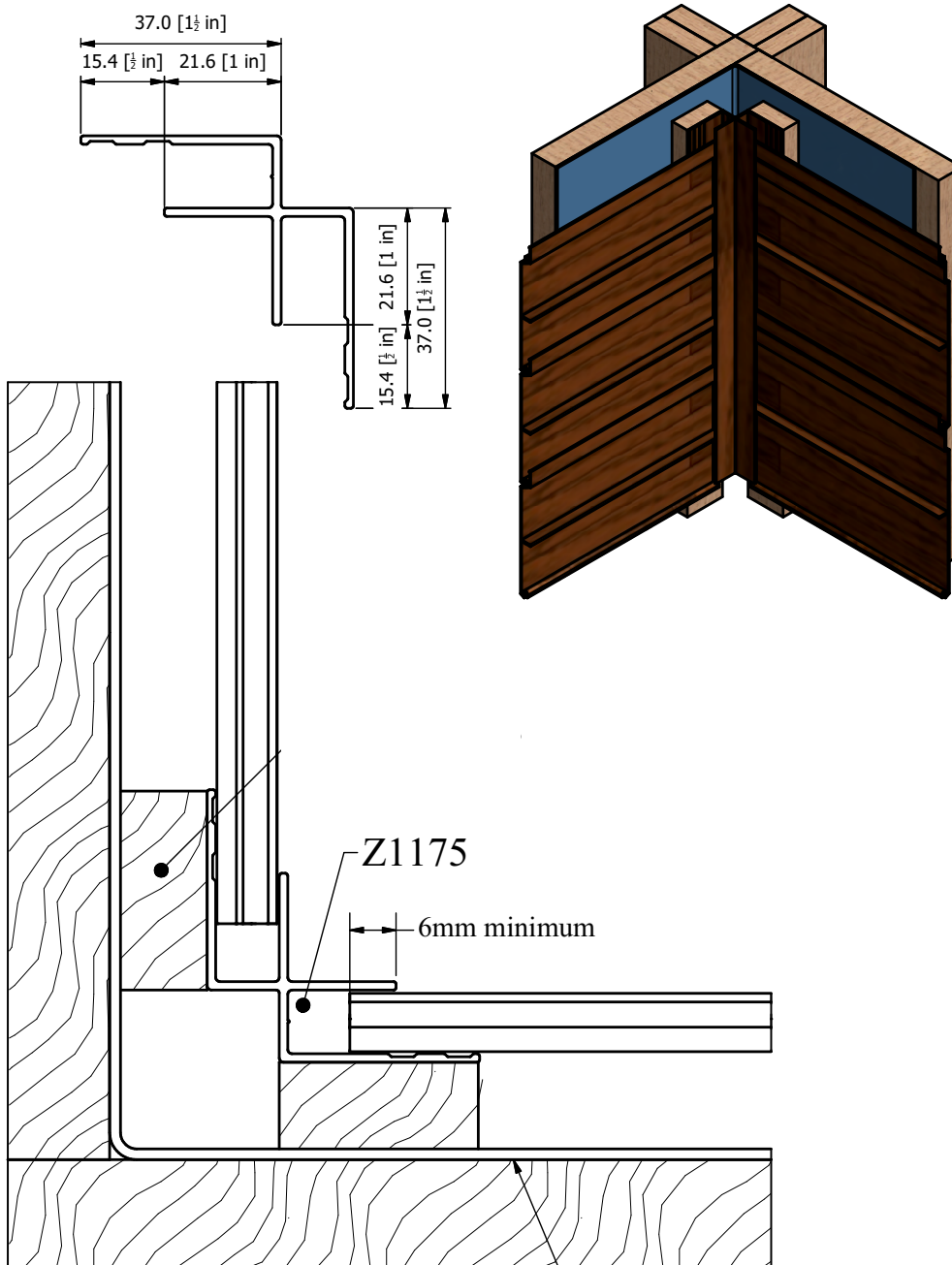

MOULURE DE BOUT END MOLDING

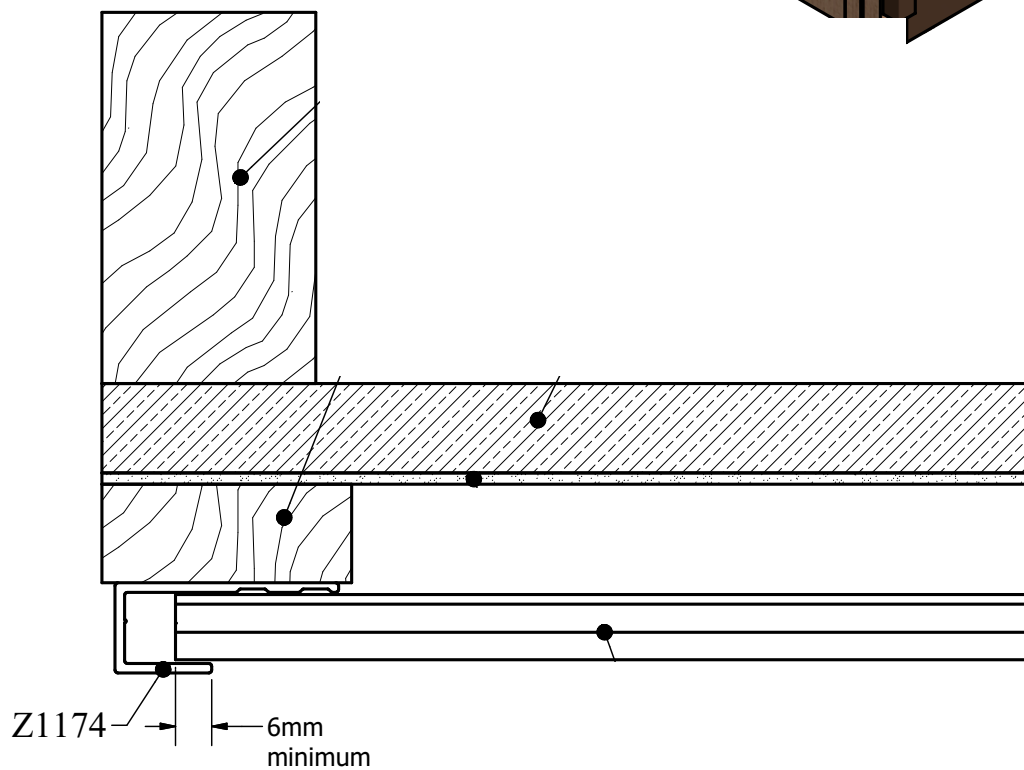
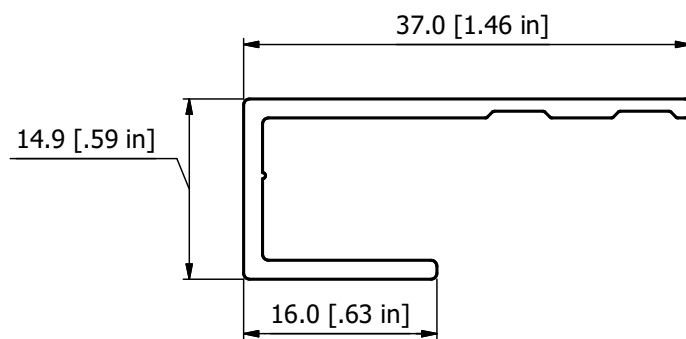

MOULURE DE MILIEU MIDDLE MOLDING

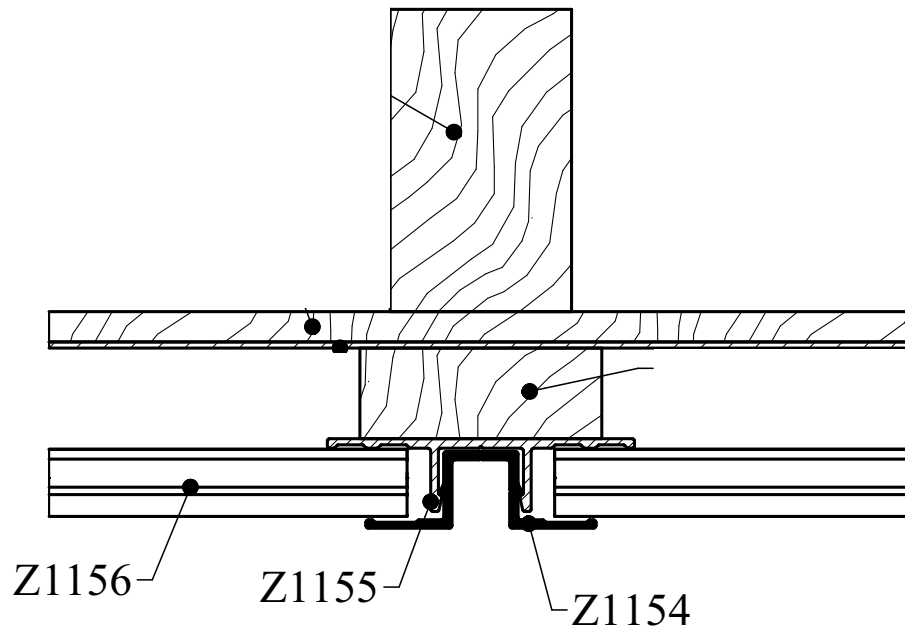
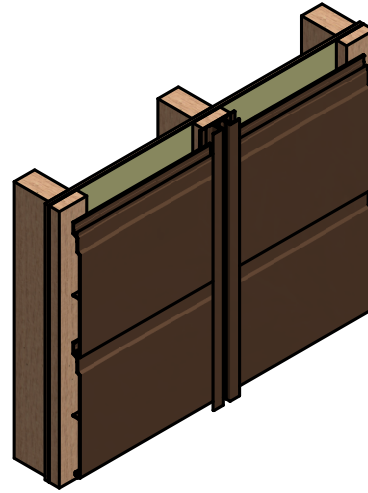
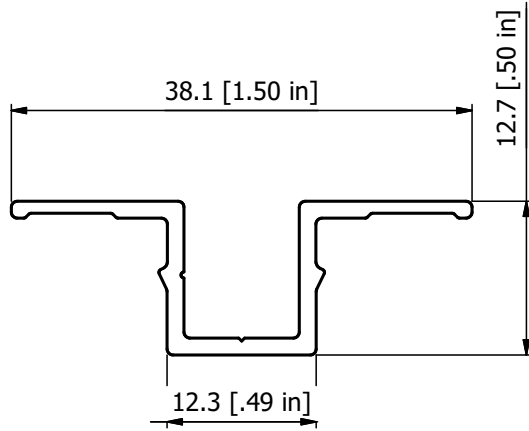

PROFILÉ MODULAIRE 4 POUCES MODULAR 4 INCHES PROFILE

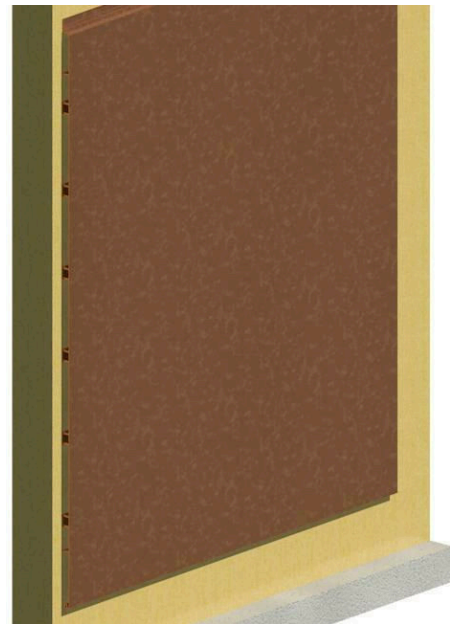
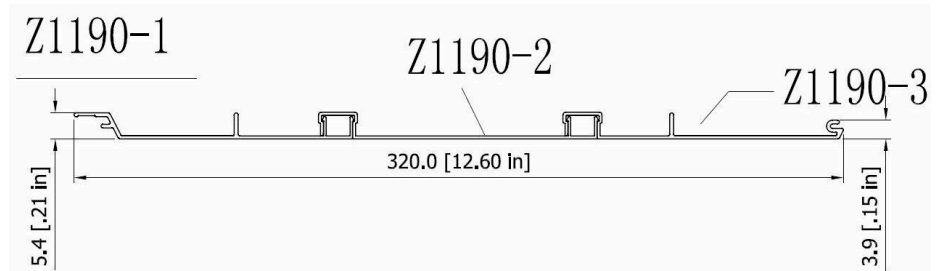

ADAPTATEUR À ANGLE ANGLE ADAPTOR

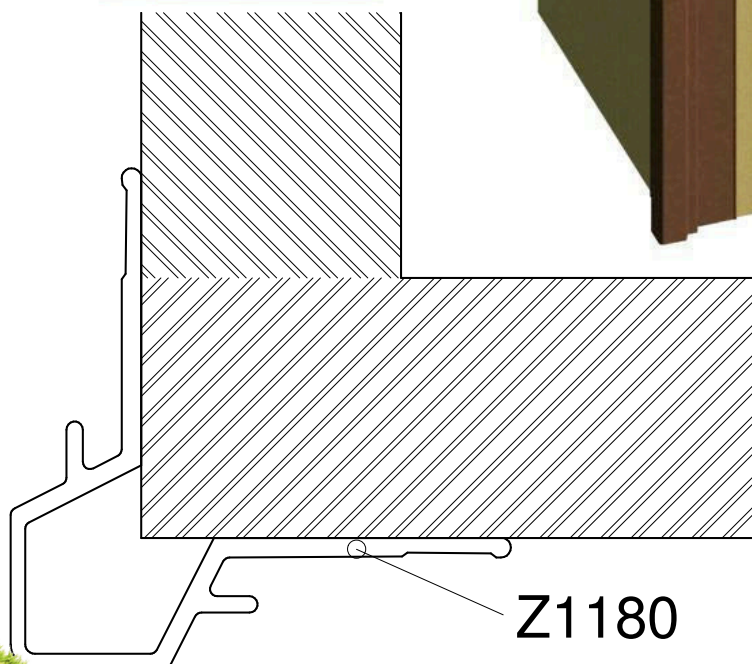
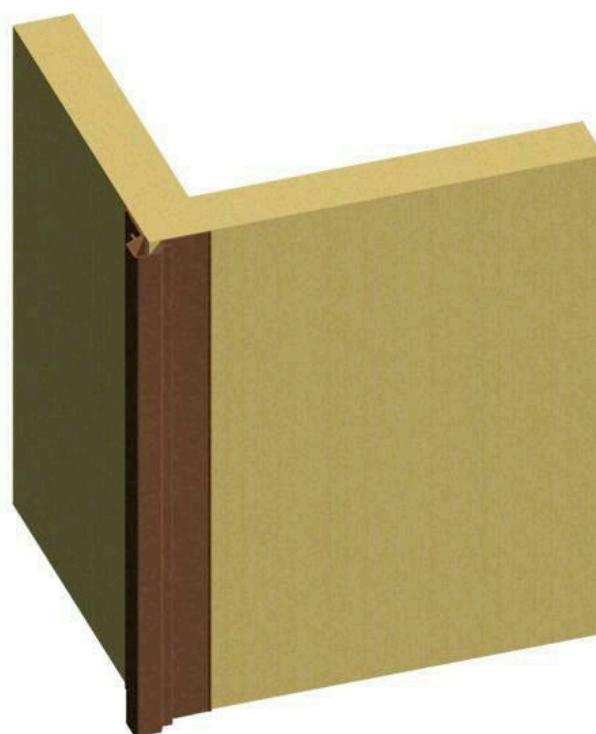
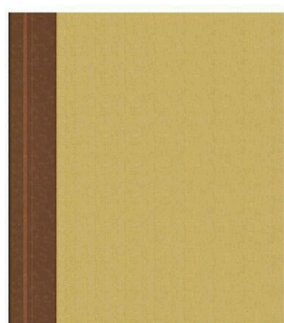
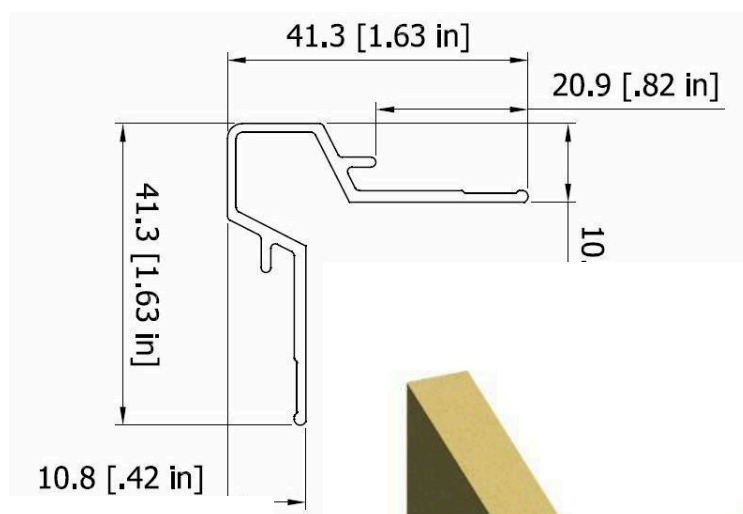

NOS VALEURS
D'INTÉGRITÉ,
D'HONNÊTETÉ
ET DE DÉPASSEMENT
DES ATTENTES DE LA CLIENTÈLE
SE REFLÈTENT DANS LE SERVICE
QUE NOUS OFFRONS.

DEPUIS 3 GÉNÉRATIONS,
NOUS METTONS TOUT EN ŒUVRE
POUR OFFRIR LE MEILLEUR
PRODUIT QUI SOIT.

OUR VALUES OF
INTEGRITY,
HONESTY
AND GOING BEYOND
CUSTOMER EXPECTATIONS
REFLECT IN THE PRODUCT
WE OFFER YOU

FOR 3 GENERATIONS,
WE HAVE BEEN WORKING HARD
AT OFFERING THE BEST
PRODUCTS POSSIBLE



CHOIX DE FINIS

CHOICE OF FINISHES

POUR UN ASPECT DE BOIS NATUREL
SANS SES DÉSAGRÉMENTS

CHEZ LUXOR
NOUS VOULONS VOUS OFFRIR
CE QUI SE FAIT DE MIEUX SUR LE MARCHÉ,
C'EST POURQUOI NOUS VOUS PROPOSONS
CHOIX DE PLUSIEURS FINIS
ET TEXTURES DIFFÉRENTES

D'AUTRES FINIS ET COULEURS SOLIDES (NOIR, BLANC...)
SONT DISPONIBLES SUR COMMANDES SPÉCIALES

CONTACTEZ-NOUS POUR UNE SOUMISSION

FOR A SPECTACULAR WOOD FINISH
WITHOUT THE MAINTENANCE ASSOCIATED TO IT

WE STRIVE AT OFFERING YOU THE BEST PRODUCT ON THE MARKET.
WE OFFER A SERIES OF STANDARD WOOD FINISHES AND TEXTURES.

OTHER WOOD FINISHES AND
RAL SOLID COLOURS (BLACK, WHITE...)
AVAILABLE ON SPECIAL ORDERS

CONTACT US

FINIS STANDARDS STANDARDS FINISHES

Finis stock / Stock finish

- ♦ 84428 - Noyer / Walnut
- ♦ 84421 - Érable / Maple
- ♦ 84383 - Chêne / Oak
- ♦ 1156-3 - Teck / Teak
- ♦ HD-878 Teck Ambré / Amber Teak

Couleurs RAL solides disponibles
RAL solid colours available

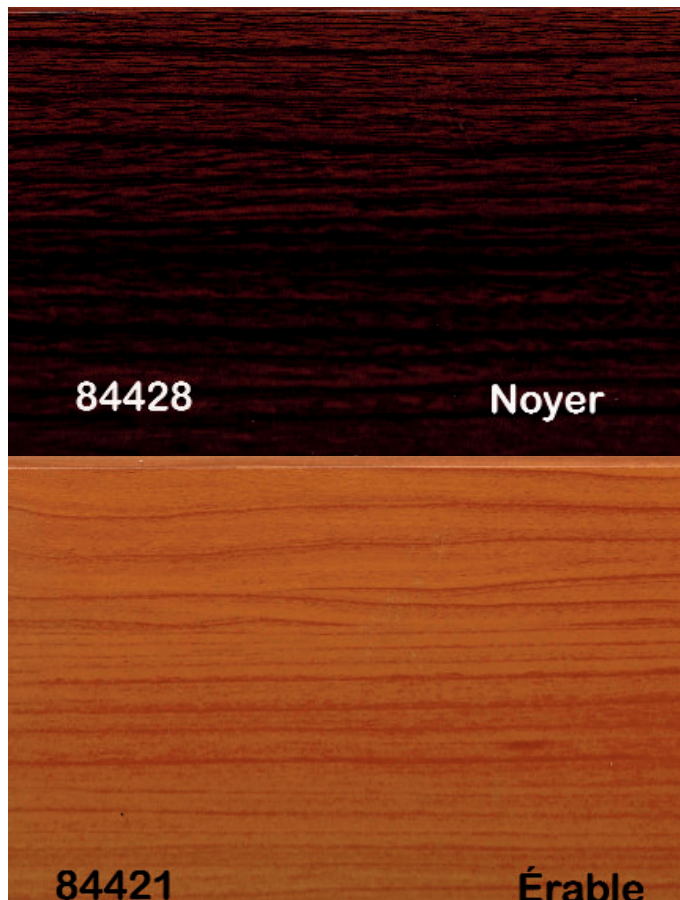
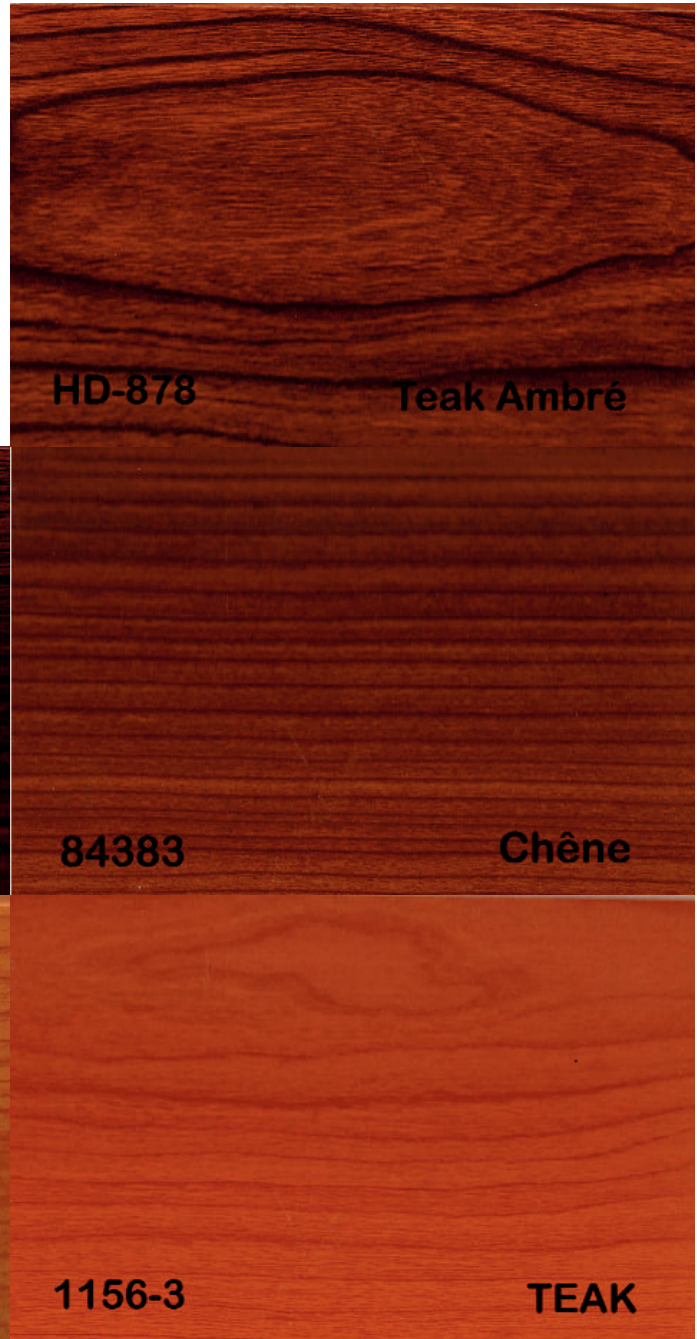



RÉALISATIONS

INSTALLATION ADRESSES



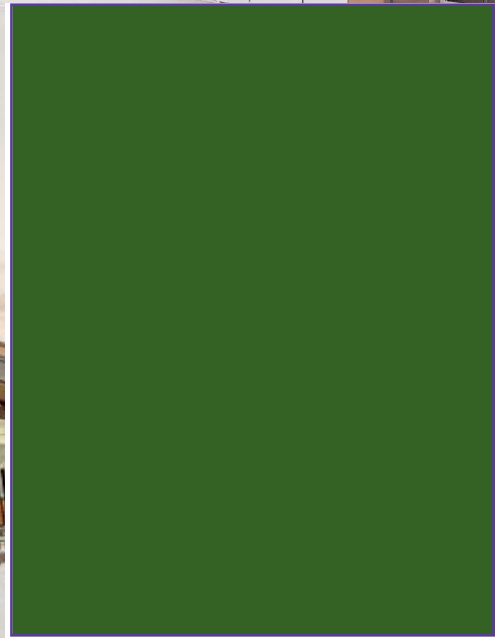

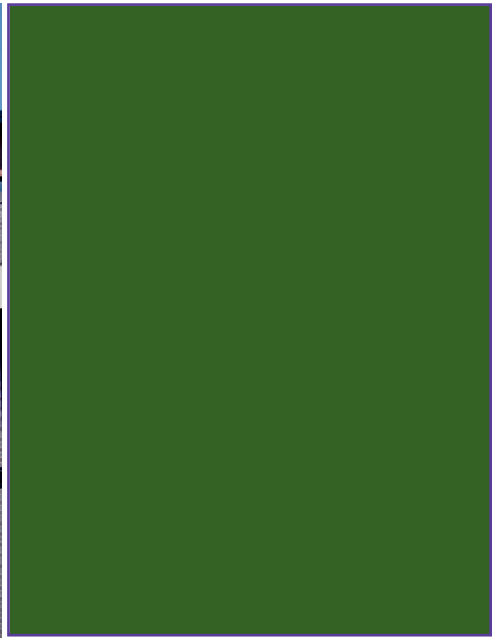



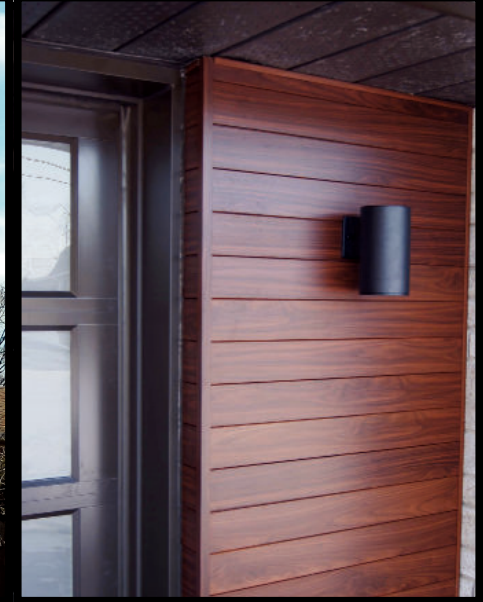







SPÉCIFICATIONS INNOVATION ET PLUS...

SPECIFICATION, INNOVATION
AND MORE...



Luxor Siding

Strength, Protection and Beauty

Luxor Designer Collection extrusion siding combines the strength and stability of aluminum with the durability Finish providing a superior shield against nature as harsh elements.

The installation of Luxor Aluminum siding is an investment that has immediate benefits. Virtually maintenance free. Luxor Aluminum siding never needs painting and wont peel, or rot.

Before starting to install;

Check the if delivery is complete and everything has arrived in good condition
Inspect product prior to application. Luxor collection siding is not responsible for the installation of blemished or damaged material.

Always use appropriate personal protection equipment. Cutting metal on a saw increases risk of eye injury

Plan your install for best finish appearance. For wood finishes make sure that you install using the best of the repeating pattern.

Do not install over pressure treated material without adequate barrier protection

How is fastened and what tools to use

A radial saw and/or small table saw with a blade for non-ferrous materials must be used, for example: a -10" 12" 80T non-ferrous metal cutting blade

Holes for lights or electrical boxes up to 4" use appropriate hole saw, larger holes will require a jig saw. Protect surface prior to cutting holes with tape to avoid chipping

The siding board should be fastened with a #8 self-drilling screw of appropriate length. This will allow product to be removed if required without damage. Screws also allow installer to back off the screw to shim if necessary or insulation.

A reasonable amount of care is essential to obtain the desired results; we recommend taping the face of the trim saw surface as well as table saw surface to prevent any scratches or marring of the finish. Cut face up if it is possible Always taped ends to cut of the corner trims and "J" A proper amount of care, as with any prefinished product, will result in a premium quality installation and a lifetime of maintenance



Easy Application Guide

Luxor Aluminum siding is tough, durable and easy to install. The following instructions provide a step by step installation for both horizontal and vertical aluminum siding. To begin your aluminum siding project, it is recommended to read this manual in its entirety before proceeding. The method of applying Luxor Aluminum siding is basically the same for new construction and remodeling. In all applications, care should be given to ensure that the structure is properly prepared. Make sure of proper ventilation of attics and crawl space areas plus correct any existing moisture problems. All walls should be smooth and plumb. Consideration should be given at this time to the installation of insulation boards over existing walls before residing.

Luxor Siding Styles and Accessories

Siding: By using the drawings below measure the height and width of wall. Enter total on materials Required Form **Gable Areas:**

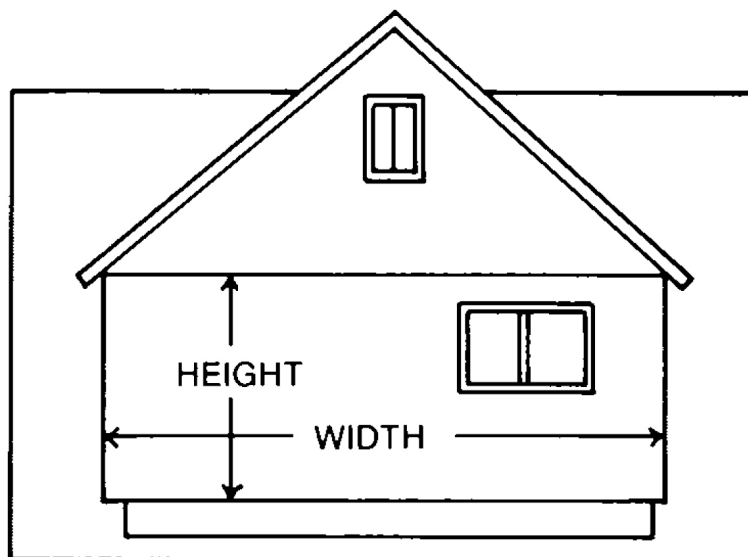

Measure height at center. Measure width to include windows
ft height x ft 1/2 width =
Repeat for remaining gable. sq ft



Gambrel Roof House:

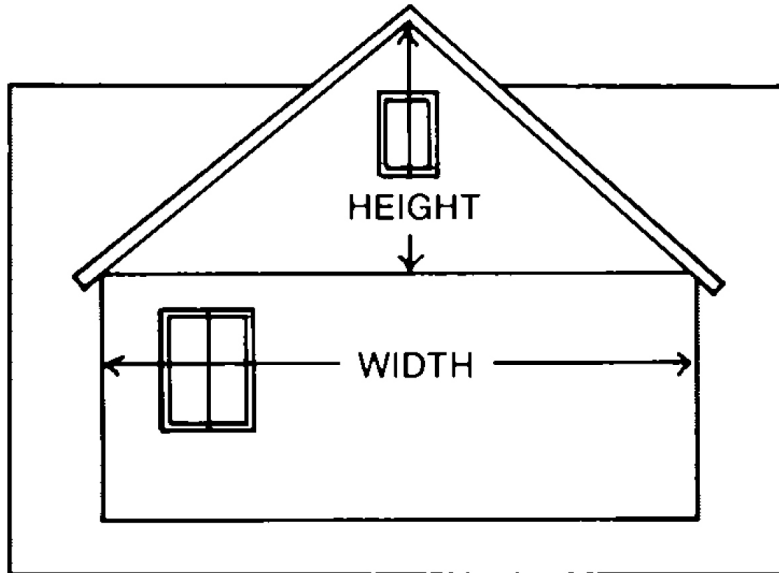

Measure height of dormer don't forget to calculate some extra for waste

ft 1/2 height x ft width = square ft

dormer area 1 side x 2 = Repeat for all dormers square ft per dormer **Wall Areas**

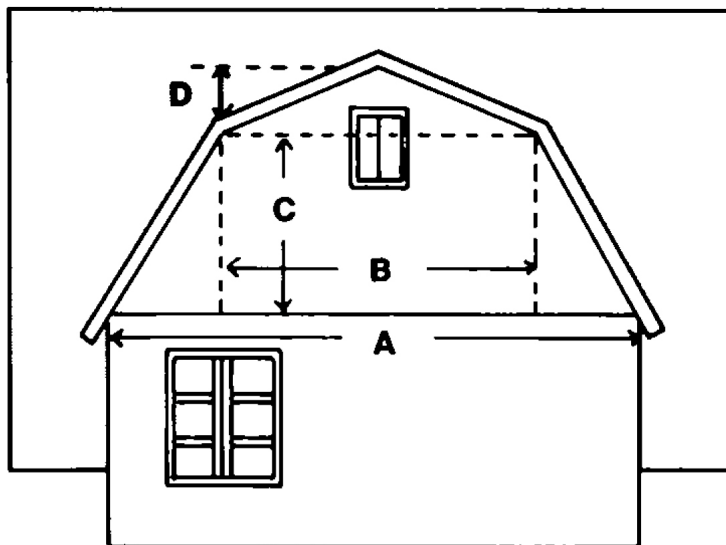

Measure height (excluding gables). Measure width to include doors and windows.

ft height x ft width = Repeat for all walls. square ft

Gambrel Roof House:

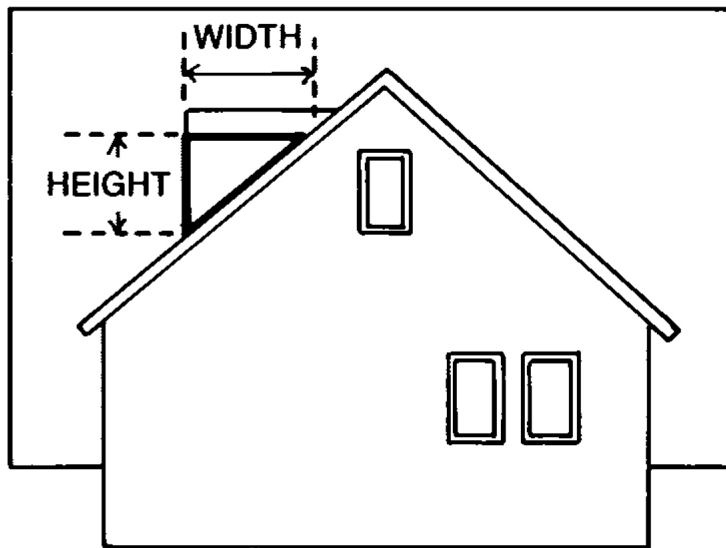

Measure the gambrel roof house as shown above to include windows and doors. Then process with the following calculations: $\frac{1}{2} (A + B) \times C =$ square ft
 $B \times \frac{1}{2}D =$ + square feet Total area:
 Repeat for all gambrel areas

Estimating Your Siding Materials

Walls square feet

Gable ends square feet

Dormer sides square feel

Gambrel walls square feel

Total wall area square feet

Subtract areas not to be (-) square feet

Covered such as garage doors

Or sliding glass doors

Total net area square feet _____

Total net square fool number _____ area 100 squares of



Siding Materials Required

J-Channel:

Measure in lineal feet around doors, windows, where dormer meets roof line or under eaves.

Starter Strip:

Measure along base of house.

Outside and Inside Corner Posts:

Measure the length of the corners.

Individual Corners:

Measure length of all outside corners and divide by 60.

Note. Add 10% to all measurements for waste.

Essential Tools & Equipment

1. Cutting Tools
 - a. Radial Saw 10" to 14"
 - b. Hacksaw with fine tooth blade
2. Carpenter level 4 foot minimum length
3. Framing square 120" x 180"
4. Drill, Hammer 12 oz.
5. Safety goggles
6. Chalk line 500'
7. Tape measure 3/4" wide
8. Nails or screw
9. Caulking Gun & Caulk

Surface Preparation

The quality of the finished job depends on good preparation of the work surface. Check for low places in the plane of the wall and build out (shim out) if required.

Prepare the entire building a few courses at a time. Securely nail all loose boards and loose wood trim. Replace any rotted boards. Scrape away old paint build-up, old caulking and hardened putty, especially around windows and doors where it might interfere with

The positioning of new trim. New caulk should be applied to prevent air infiltration.

Remove downspouts and other items which would interfere with installation of new siding.

Tie back shrubbery and trees from the base of the building to avoid damage to the landscaping.

Window sill extensions may be cut off so J-trim can be installed flush with window casing. Alternatively, to maintain the original window design, coil stock can be custom-formed around the sill instead of cutting away the sill extensions.



Wood Furring

Furring is building out from the wall surface to provide a smooth even base for nailing on the new siding. Lath strips 3/8 inch thick are most commonly used. Lumber strips 1" x 3" are often used over brick and masonry. Furring is not usually necessary in new construction, but older homes often have uneven walls, and furring out low spots, or shimming, can help prevent a wavy appearance to the siding installation. Furring should be installed vertically 16 inches on center for horizontal siding, and the air space at the base of siding should be closed off with strips applied horizontally. Window, door, gable, and cave trim may have to be built out to match the thickness of the wall furring.

Vertical Siding

Furring for vertical siding is essentially the same as for horizontal siding, except the wood strips are securely nailed horizontally into structural lumber on 16 to 24 inch centers. When using 1" x 3" furring, again be sure to check what effect the additional thickness might have on trim situations.

Chalk Lines

Straight Line

The key element in a successful siding installation is establishing a straight reference line upon which to start the first course of siding. The suggested procedure is to measure equal distances downward from the eaves and/or windows. This insures that the siding appears parallel with the eaves, soffit, and windows, regardless of any actual setting of the house from true level. Find the lowest corner of the house. Partly drive a nail about 10 inches above the lowest corner, or enough to clear the height of a full siding panel. Stretch a taut chalk line from this corner to similar nail installed at other corner. Re-set this line based upon measuring down from points of equal dimension from eaves or windows. Repeat this procedure on all sides of the house until the chalk lines meet at all corners. Before snapping chalk lines, check for straightness. Be alert to sag in the middle, particularly if line is more than 20 feet long. If preferred, lines may be left in place while installing the starter strip, as long as they are checked periodically for excess sag.

Level

If the house is reasonably level, an alternative is to use a level to set the chalk line approximately 2 inches (Or the width of the starter strip) from the lowest point of the old siding, and locate the top of the starter strip to that line. Be careful when using a standard carpenter's level because the progressive measurements may increase the possibility of error. The level should be at least 2 feet long, and preferably longer. Take level reading at center of chalk line for best results.

Screw

Hanging the Siding

Siding is hung on with the screw to the wall.

Drive the self-tapping or regular screw through the flange top of the board snug but not too tight. That permits the siding to get the other board freely. Siding screw too tightly may produce an unattractive wavy appearance.

Screw

When screw the siding and accessories, always use aluminum or galvanized steel. Screw should be driven straight and level, never slanted up or down so as to possibly cause distortion of the panel. Use 1 1/2" screw [or longer], as well as most trim accessories.



Screwing Centers

Siding screw should be spaced on approximately 16 inch centers and should not be driven closer than 6 inches from panel joint. On new construction, screw into the studs on 16 inch centers. Do not skip studs. In remodelling, when siding is installed over old wood, be sure that rotted or broken boards are not used as the nailing base.

Cutting Luxor Aluminum Siding

Radial on bench saw Cutter

For accurate factory cuts of siding panels without damage to panel a radial saw is the preferred cutting tool. Different cutting blades can be used but 80T non-ferrous metal cutting blade is recommended make sure that the siding is square to the blade to avoid uneven cut

IMPORTANT NOTE

Always tape the surface if you cut face down this will avoid scratch and marring on the finish surface

Saw Cuts

Use a hacksaw to cut accessories like corner posts.

Power saws designed for cutting metal may be used to cut panels which are going into a J-channel, corner post or other receiver.

Starter Strip

Horizontal Siding

Using the chalk line or string as a guide, install starter strip all the way around the bottom of the building. It is extremely important that the starter strip be straight and meet accurately at all corners, since it will determine the line of all sitting panels installed. Check starter strip and chalk line with a level to be sure starter strip is in the right place.

Vertical Siding

A plumb line should be used when applying starter strip in a vertical position.

Inside Corner Posts

Installation

Inside corner posts are used to receive siding at insets and wall meeting points and are installed before the siding is hung. The post is set in the corner full length, reaching from 1/4-inch below bottom of starter strip up to cave or gable trim. Using a framing square to insure a proper 90 degree angle nail approximately every 12 inches on both flanges with steel nails. Make sure post is set straight and true. If a short section is required, use a hacksaw to cut. If a long section is required, posts should be overlapped with the upper piece outside.

Outside Corner Posts

Installation

The outside corner post provides a trim appearance to siding application. Outside corner posts are designed to be installed before the siding is hung, in a manner similar to the inside Corner post. Set a full length piece over the existing corner running from 1/4-Inch below the bottom of starter strip to the underside of the eave. If a long corner post is needed, overlap corner post sections with the upper piece outside.

Screw

Screw every 12 inches with steel screws on both flanges. Make sure flanges are securely screw, but avoid distortion caused by overdriving the screws.



Trim

J-channel is used around windows and doors to receive siding. Side J-channel members are cut longer than the height of the window or door, and notched at the top as shown. Notch the top J-channel member at a 45 degree angle and bend tab down to provide flashing over side members. Caulking should be used behind J-channel members to prevent water infiltration between window and channel.

Clean up

Keep hands as clean as possible during application, or use clean work gloves. To clean smudges, use a soil cloth or damp sponge dipped in mild detergent solution or in soap and water. Avoid rubbing too hard which might create a glossy area on the finish surface. Never use harsh abrasive cleaners. Thoroughly clean off any residue. You might use Methyl Hydrate

MAINTENANCE

As with all exterior covering, dirt can accumulate. Periodic cleaning of these surfaces is often necessary. Such cleaning can be achieved with either a garden hose or with a mild cleaner. Do not use a pressure washer or any solvents to accomplish this.



Luxor Architectural offre une garantie de 20 ans de la surface peint sur le matériel, appliqué dans des conditions atmosphériques normales.

La finition du revêtement super durable ne s'écaillera, cloquera, blanchira et décolorera pas sur la surface, et qui pourrait affecter l'apparence du fini.

- ♦ Le fini super durable a été analysé et vérifié par des organismes certifiés qui garantit dans le monde entier l'aptitude du produit pour un usage externe ainsi qu'une résistance élevée aux agents atmosphériques.
- ♦ Le fini super durable et procédé a été soumis à une série d'essais pour évaluer l'indice de résistance aux U.V selon les méthodes établie par la norme ISO 105/B02-08 correspondant à la norme UNI 7639-89. Dans tous ces rapports d'essais, établis par différents laboratoires, l'indice de résistance aux U.V est indiqué pour nos produits, et quand ce dernier est de 7 ou plus, cela signifie que cette finition est conforme à propos de la résistance U.V.
- ♦ Ces essais étant de type accéléré, n'ont pas de rapport avec l'exposition externe, au cours de laquelle il est normal qu'il se produise un certain type de dégradation avec le temps (dégradation relative aux conditions atmosphériques du milieu où est exposé le produit fini). Nous pouvons dire que les produits contrôlés et testés sont conformes voire même dépassent les conditions requises par les tableaux de normalisations internationales parmi lesquels le Qualicoat et le AAMA -2604 y est diffusé.
- ♦ L'aspect d'un produit exposé peut être compromis ou subir des dégradations au fil du temps selon les conditions atmosphériques de la zone ou le produit est exposé (exemple : zones urbaines, zones industrielles, zones marines, zones industrielles marines, zones tropicales).
- ♦ Il est donc important que le nettoyage et l'entretiens nécessaires soient faits deux à trois fois par an selon les besoins.

Cette garantie ne s'applique pas au dommage engendré à la moisissure ou toute contamination nuisible au fini dû à un mauvais entreposage transport, emballage manutention du matériel dommage dû à l'eau avant son installation.

Cette garantie ne s'applique pas si le dommage est causé par un acte de Dieu, tornades, ouragans, forts vents, verglas et des forces extérieurs hors du contrôle et imprévisible par Luxor Architectural.

Advenant une réclamation, le client devra fournir la preuve de la date de l'installation du matériel et démontrer la défaillance du fini ainsi que laisser à Luxor Architectural l'opportunité de faire une inspection de la surface.

La garantie s'applique à remplacer les pièces défectueuses et Luxor Architectural ne sera pas responsable du démantèlement, le transport et la réinstallation des pièces repeintes.

La garantie ne s'applique qu'aux produits finis bois Luxor Architectural et installés dans la province de Québec



FINISH WARRANTY

Luxor Architectural offers a warranty of 20 years on the painted surface of the material applied under normal atmospheric conditions.

- ◆ 1.0 The Super Durable Finish (SDF) on the product won't flake, blister, crack or fade on the surface, which could affect the appearance of the finish.
- ◆ 2.0 The Super Durable Finish (SDF) is analyzed and verified by certified organizations that guarantees worldwide the suitability of the product for external usage as well as high resistance to atmospheric agents.
- ◆ 3.0 The Super Durable Finish (SDF) underwent a series of tests to assess the resistance to UV index according to the methods established by the standard ISO 105 B02-08 standard UNI 7639-89. In all these test reports, established by different laboratories, resistance to the UV index is indicated for our products, and when the latter is 7 or more, it means that this finish is consistent about UV resistance. These tests being accelerated type have no connection with external exposure, during which it is normal to occur a certain type of degradation with time (degradation on atmospheric conditions of the environment where the finished product is exposed). We can say that controlled and tested products conform or even exceed the conditions required by the tables of international standardization including the Qualicoat and the AAMA – 2604 (American Aluminum Manufacturing Association) (see attach document)
- ◆ 4.0 The appearance of a product displayed may be compromised or suffer degradation over time depending on the weather conditions of the area or the product is exposed (example: urban areas, industrial zones, marine areas, marine zones, tropical areas). It is therefore very important and decisive that the cleaning and the maintenance be made two (2) to six (6) times per year depending on the needs. It is very important to keep the maintenance program documented.
- ◆ 5.0 The maintenance programme should be done by washing with a soft sponge or cloth mild detergent with water and rinse rapidly with tap water to avoid soap residues to stay on the surface. Avoid pressure washer and hard detergent you could damage the surface
- ◆ 6.0 This warranty does not apply to damage caused by mold or contamination harmful to finish due to improper storage transport, packaging handling equipment damage due to water before installation.

This warranty does not apply if the damage is caused by an Act of God: tornadoes, hurricanes, strong winds, sleet, external forces and unpredictable occurrences by Luxor Architectural.

In the event of a claim the customer will have to provide proof of the date of installation of the equipment and demonstrate the failure of the finish. It will also have to provide proof of such maintenance as mentioned above and will give Luxor Architectural the opportunity to make an inspection of the surface and the documents certifying the maintenance of the surface. Luxor Architectural will not be held responsible for workmanships of any installer or have any liability for unsatisfactory caused by a faulty installation.

The warranty applies to replace the defective parts and Luxor Architectural is not liable for the dismantling, transport and reinstallation of the painted parts and the color change from the original finish. The warranty applies only to the product fabricated by Luxor Architectural and installed in Canada.

Registration is mandatory within 30 days after the date of purchase in order for the warranty to be in effect.



GARANTIE

SVP enregistrer votre projet et le nom de votre entreprise et nous en faire parvenir une copie à Luxor Architectural afin de valider la garantie.

Please register the project and company and send a copy to Luxor Architectural to confirm the warranty

Description du produit / Product description

Date: _____

Nom Propriétaire ou contracteurs / Name Owner or Contractor : _____

Projet / Project : _____

Adresse de l'installation / Address of installation : _____

Date de la fin des travaux / Date of completion : _____

Remarque / Remark:

J'ai lu et accepte les termes de la garantie de Luxor Architectural

I have read and agree to the term of Luxor Architectural warranty

Nom Propriétaire ou contracteurs / Name Owner or contractor

Signature





CONTACTEZ-NOUS

Tél: (514) 585-6558

Fax: (450) 857-1239

www.luxorweb.ca

info@luxorweb.ca